

Product Information Bulletin

64 Outwater Lane, Garfield, NJ 07026 Ph: 973-340-7889 | Fax: 973-340-7809

2-3/8" Round Post Breakaway Coupler

Made of cast gray iron, withstands winds of 120 mph.

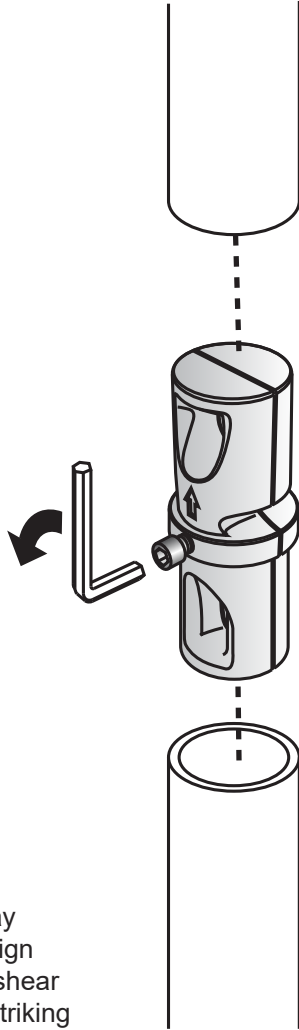

Brimar's Part #: Y3555
Color: Rust-resistant Galvanized
Diameter: 2-3/8"
Gauge: 8 to 16 gauge
Foundation: Soil
Weight: 5.5 lbs.

Brimar's Part Number:
 3 ft = Y3556
Color: Rust-resistant Galvanized
Diameter: 2-3/8"
Gauge: 12 gauge
Material: Tubular Steel
Wall Thickness: 0.109"
Type: Anchor Post
Sizes: 3 ft. Anchor,
Weight:
 3 ft = 8.15 lbs.

SNAP'n SAFE round Sign Post Breakaway is an NCHRP 350 compliant breakaway sign post system that is designed with a 360° shear point that will prevent the sign post from striking and penetrating the windshield or roof of a vehicle when impacted during a collision. It also helps save money on repairs by saving the anchor post and requiring less labor for repairs.

This breakaway round post system is available for 2-3/8" sign posts.

Easy installation: Simply insert SNAP'n SAFE Coupler in anchor and bottom of sign post and tighten the set screw.

Made of cast gray iron, 80% of which is recycled material, and they can also withstand winds of up to 120 mph.

All necessary hardware is included to connect the assembly to both the anchor post and sign post.

DATE: ___ / ___ / ___ **JOB:** _____

CONTRACTOR: _____